

**157 Lower Richmond Road  
Putney London  
SW15 1HH**



**742 Sq. ft (69.00 Sq. m) approx.**

**COMMERCIAL UNIT**

**FOR SALE**

**0208 332 7788**

Suite A, 1 Hill Rise, Richmond upon Thames TW10 6UQ

[www.michaelrogers.co.uk](http://www.michaelrogers.co.uk)

## Location:

The building is located in Putney which is an affluent London suburb located some 5 miles south-west of central London. It is located on Lower Richmond Road close to Stanbridge Road. Putney Bridge Underground station and Putney Rail are a short distance away. Lower Richmond Road is in the heart of Putney, a high value residential area. There are many retailers close by including Sainsburys Local. Most retailers are independents.

## Description:

The unit is arranged over ground and lower ground floors. The unit is part of a terrace and is currently being used as an office.

## Amenities:

- Self-contained
- Timber/tiled floors
- Comfort cooling & heating
- Under floor heating
- Spot lighting
- Part partitioned
- Storage areas
- Light wells
- WC
- Kitchenette
- Tanked basement
- Electric blinds



## Accommodation:

FLOOR	SQ FT	SQ M
Ground	371	34.50
Basement	371	34.50
<b>TOTAL</b>	<b>742</b>	<b>69.00</b>

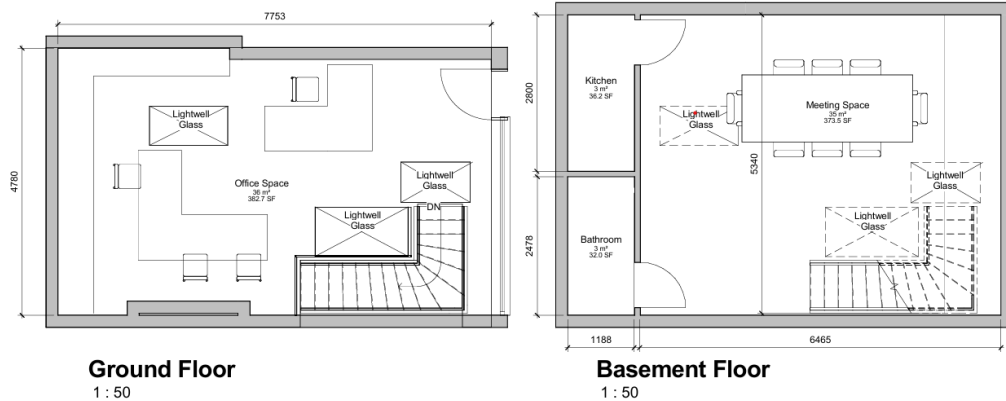

## Terms:

The building is available Freehold.

The upper floor has been sold off on a long lease.

## Price:

Upon application.

The building is elected for VAT.

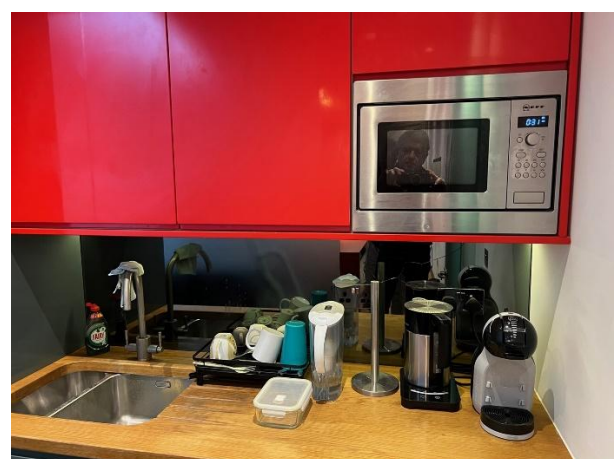

## Service charge:

Upon application.



### **Business Rates:**

The rateable value from 1<sup>st</sup> April 2026 will be £12,500 giving rates payable of £4,775.00 per annum.

Interested parties are advised to make their own enquiries with the Valuation Office Agency.

### **Energy Performance Certificate:**

Upon application.

### **Anti Money Laundering:**

Michael Rogers LLP is regulated by the RICS and by HMRC in relation to its agency services and as a result is obliged to undertake anti money laundering checks on all parties proceeding with property transactions. We cannot proceed with any relevant property transactions without these checks having been satisfactorily completed and you will be asked to provide information to satisfy such checks.

### **For further information please contact sole agents:**

Michael Rogers LLP. Tel: 020 8332 7788

Niall Christian Tel: 07780 678684 Email: [niall.christian@michaelrogers.co.uk](mailto:niall.christian@michaelrogers.co.uk)

Joshua Thompson Tel: 0759 910 7005 Email: [joshua.thompson@michaelrogers.co.uk](mailto:joshua.thompson@michaelrogers.co.uk)

Subject to Contract  
May 2026

The accuracy of any description, references to condition, necessary permissions for use and occupation and other details contained herein is not guaranteed and is for general guidance only and prospective purchasers or tenants must not rely on them as statements of fact or representations and must satisfy themselves as to their accuracy. Neither Michael Rogers LLP, nor any of its employees or representatives has any authority to make or give any representation or warranty or enter into any contract whatsoever in relation to the property. Rents quoted in these particulars may be subject to VAT in addition. The reference to any mechanical or electrical equipment or other facilities at the property shall not constitute a representation (unless otherwise stated) as to its state or condition or that it is capable of fulfilling its intended function. Prospective tenants/purchasers should satisfy themselves as to the fitness of such equipment for their requirements.

Michael Rogers LLP is a Limited Liability Partnership registered in England (Number OC344608). Registered Office: Chapter House, 33 London Road, Reigate, Surrey, RH2 9HZ

**Regulated by RICS**